

# Motion Ride Theater

## “The world's best realistic ride”

### Motion Ride Theater



Motion Ride Theater features high efficiency 6 axis electric motion platform and digital visual & audio systems with seating 8 persons up to more than 100 persons.

Motion Ride Theater incorporates remote control hardware/software and various customer choice 2D/3D ride films with Motion programming of Simuline's in-house motion editing/analysis software that makes dynamic movement.

We guarantee the highest realism and excitement and is ready to not only satisfy any customer needs but also suit the customer's budget.

### Applications



- + High efficiency electric 6DOF motion system
- + Available in 8 seats up to more than 100 seats
- + Synchronized operation of multiple simulators
- + 200inch, 400inch screen, digital projection system.



- + 5.1 channel digital sound system
- + High standard visual sound system available
- + 4D special effects available like wind, leg tickler, face jet, vibration and others
- + Safety belt or safe guide bar sensor devices



- + Remote control operation system
- + Exciting and realistic motion programming provided
- + Various ride movies

## Site Location



## Single System Size Layout

### + Standard Ride Theater Layout

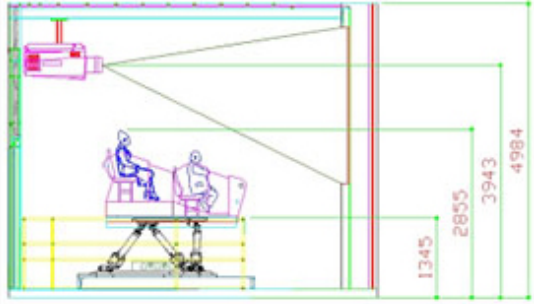
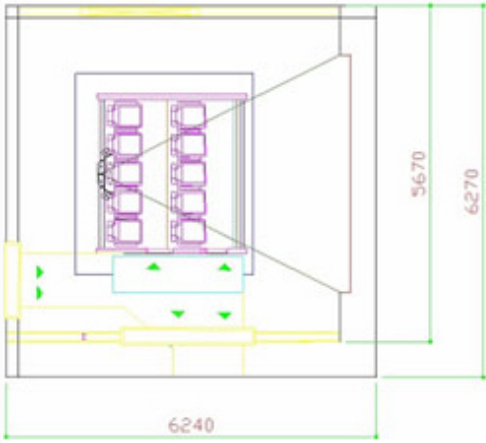

### + 10 Passengers Theater

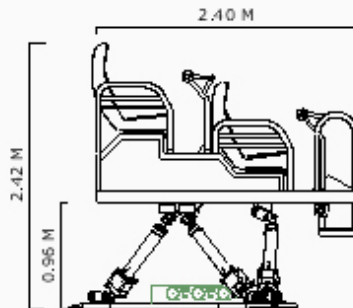
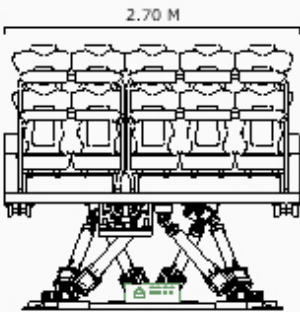

### + 20 passengers Theater layout

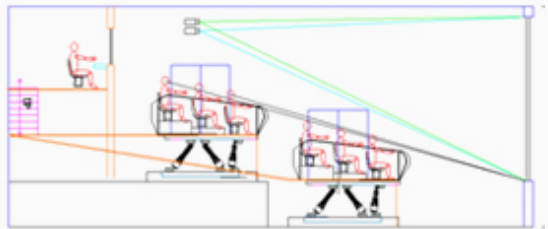
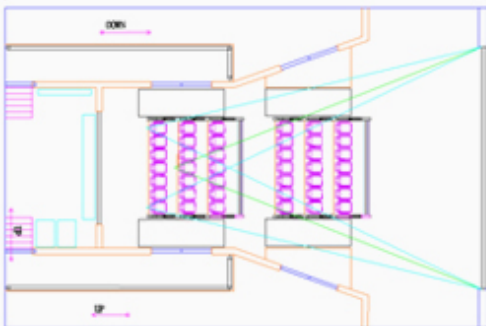

### + 100 passengers Theater layout

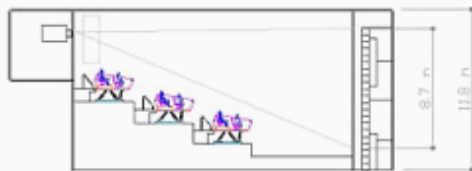

### + Installation Specifications

- Electric Supply : 3 Phase 220 VAC, 60Hz, 15KVA  
1 Phase 220 VAC, 60Hz, 2KVA
- Height : 2.6m
- Flying Seat Frame Size : 2.8m×2.4m
- System Weight : 1380kg (Total, Not included Person weight)  
680kg (Motionbase), 700kg (Flying Seat Frame)
- Floor Loading Compressing : 560 kg-f/m<sup>2</sup>
- Floor Facility : Concrete floor and anchoring